



**River Forest Park District**

**REQUEST FOR BID**

**KEYSTONE BATTING CAGES PROJECT  
(CHAIN LINK FENCE)**

401 Thatcher Avenue • River Forest, IL 60305 • 708.366.6660  
[www.rfparks.com](http://www.rfparks.com)

## NOTICE TO CONTRACTORS

**Sealed written bids** for the River Forest Park District's **2022 Keystone Park Batting Cages Project**, shall be received until 10:00 a.m. local time, August 4, 2022, at which time they will be publicly opened and read aloud.

Specifications are available at [www.rfparks.com](http://www.rfparks.com), About Us, Bids, starting July 8, 2022. This is a State of Illinois/Cook County prevailing wage project with a certified payroll to be turned into the park district.

Ten percent (10%) Bid Surety is required on this project. The successful contractor must be able to provide a satisfactory Performance Bond, Labor and Material Bond, and required proof of insurance within ten (10) days of the award of the contract.

The Board of Commissioners of the River Forest Park District reserves the right to reject any or all proposals and to waive any technicalities or formalities which it deems to be in the best interest of the District.

All work must be warranted for one (1) years from date of acceptance.

All prices are F.O.B. River Forest, Illinois. Any questions regarding this bid should be directed to Michael Sletten, Executive Director, at [msletten@rfparks.com](mailto:msletten@rfparks.com) or (708) 366-6660.

## GENERAL CONDITIONS

**Scope of Work:** Follow plans and details as provided. The project shall consist of the following: providing all labor and materials to excavate and pour 27 concrete footings; install 27-3" OD galvanized upright posts; install 1-5/8" OD galvanized base, mid, and top rails; install 2-3" OD top rails for support; install 2-7'x3' gate doors with hinges and closing devices; install 12' high heavy wire mesh (6 gauge, black PCV coated) on all walls; weld all pipes together (no fittings accepted).

The contractor is responsible for the restoration to any damaged park facilities and properties.

Specifications:

1. Excavate 27-42" footing. Install 27-3"OD galvanized poles 12' off finished grade (top of concrete); 1-5/8" base, mid and top rails, and 2-3" OD top rails for support. All rails must be welded (no fittings accepted). Spoils of excavation must be cleared and removed immediately.

Note #1: The concrete contractor will excavate the site prior to the installation on the posts. The concrete contractor shall be allowed to complete the installation of the concrete pad prior to the installation of the mesh.

Note# 2: The Park District is responsible for painting all poles and rails black prior to the installation of the mesh.

2. Installation of heavy wire mesh (6 gauge, black PVC coated) on all walls. Mesh must be within 1" of top of finished surface.
3. Installation of 1-7'x3' gate doors with hinges and closing devices. Gates frame and hardware shall be painted black by the contractor. Mesh (6 gauge) shall be PVC coated black.

**Qualifications of Contractors:** This project is open to all qualified contractors who have completed at least two (2) similar applications completed by said contractor that have been in service a minimum of two (2) years; and supply the locations, dates completed.

**Completion of Schedule:** The contractor shall begin this project on August 29, 2022, and complete this project on or before September 30, 2022.

**Prevailing Wage:** The contractor must pay the prevailing wage for each trade involved in this project as specified by the State of Illinois Department of Labor.

**Guarantee:** The successful contractor shall guarantee the work specified herein against defective materials or faulty workmanship for a period of one (1) year following the date of acceptance by the Park District.

**Insurance Requirements:** The successful bidder shall file with the Park District a certificate of insurance in the amount of \$1,000,000 for general and automobile liability. Workers Compensation Insurance shall be provided in accordance with State law. The **River Forest Park District** shall be named as an additional insured on all policies affecting the contract at no extra expense to the District.

**Withdrawal of Bids:** Bids must be firm for sixty (60) days after opening.

**Right Reserved By The Park District:** The District reserves the right to waive any informality and/or reject any or all proposals when, in the opinion of the District, such action serves the best

interests of the District. Unless proposals are rejected, the contract will be awarded to the lowest responsible, qualified proposal.

### **COMMENTS**

1. Contractor is responsible to contact JULIE for utility locate. The Park District will be responsible for locating underground security light and athletic field light utilities.
2. Access to the project site is limited, via Central Avenue. The contractor will be required to place plywood board protection over the grass. The contractor is responsible for all damages to park grounds and facilities.
3. The Park District is responsible to remove and stumps grind all trees that are currently located in the project area.

## PROPOSAL FORM

The undersigned proposed to furnish all labor, materials, tools, equipment, and perform all necessary requirements for The Depot Improvements as specified in accordance with the attached conditions and specifications, and at the terms and schedule prices herein given. The **River Forest Park District** reserves the right to award any or all items in its own best interests.

### Bid Item

#### **Specifications:**

1. Excavate 27-42" footing. Install 27-3"OD galvanized poles 12' off finished grade (top of concrete); 1-5/8" base, mid and top rails, and 2-3" OD top rails for support. All rails must be welded (no fittings accepted). Spoils of excavation must be cleared and removed immediately.

Note #1: The concrete contractor will excavate the site prior to the installation on the posts. The concrete contractor shall be allowed to complete the installation of the concrete pad prior to the installation of the mesh.

Note# 2: The Park District is responsible for painting all poles and rails black prior to the installation of the mesh.

2. Installation of heavy wire mesh (6 gauge, black PVC coated) on all walls. Mesh must be within 1" of top of finished surface.
3. Installation of 1-7'x3' gate doors with hinges and closing devices. Gates frame and hardware shall be painted black by the contractor. Mesh (6 gauge) shall be PVC coated black.

Base Total \$ \_\_\_\_\_

Authorized Agent: \_\_\_\_\_

Print Name: \_\_\_\_\_

Title: \_\_\_\_\_

Address: \_\_\_\_\_

City/State/Zip: \_\_\_\_\_

Telephone: \_\_\_\_\_

Email: \_\_\_\_\_

Date: \_\_\_\_\_

Employee Tax ID #: \_\_\_\_\_

## CONTRACT

This agreement, made and entered into this \_\_\_\_\_ day of \_\_\_\_\_, 2022, by and between the **River Forest Park District**, party of the first part, hereinafter referred to as the "District", and

\_\_\_\_\_,  
party of the second part, hereinafter referred to as the "Contractor".

## WITNESSETH

WHEREAS, the District has heretofore caused to be prepared certain specifications and proposal forms, dated the \_\_\_\_\_ day of \_\_\_\_\_, 2022, for The Keystone Batting Cages Project under the terms and conditions therein fully stated and set forth, and

WHEREAS, said specifications and proposal forms accurately and fully describe the terms and conditions upon which the Contractor is willing to perform the Keystone Park East Playground Installation Project as specified.

## NOW THEREFORE, IT IS AGREED

1. That the District hereby accepts the bid of the Contractor for the sum listed on the attached sheet to this Contract.
  
2. That this Contract consists of the following components which are made part of this Agreement and Contract as fully and absolutely as if they were set out in detail in this Contract.
  - Notice to Contractors
  - General Condition
  - Specifications and Drawings
  - Proposal Form
  - Contract
  
3. That payment is to be made to the Contractor within thirty (30) days of the acceptance and completion of the work as ordered by the District

\_\_\_\_\_

CERTIFICATE OF COMPLIANCE  
WITH ARTICLE 33E OF THE  
CRIMINAL CODE OF 1961

The undersigned, \_\_\_\_\_, being the Contractor submitting a proposal for the public project as described in these proposal documents, hereby certifies that the undersigned is not barred from bidding on the public contract as a result of a violation of either Sec. 33E-3 or Sec. 33E-4 of Article 33E of the Criminal Code of 1961, approved July 28, 1961, as amended.

Dated: \_\_\_\_\_

Contractor

By: \_\_\_\_\_

Attest: \_\_\_\_\_

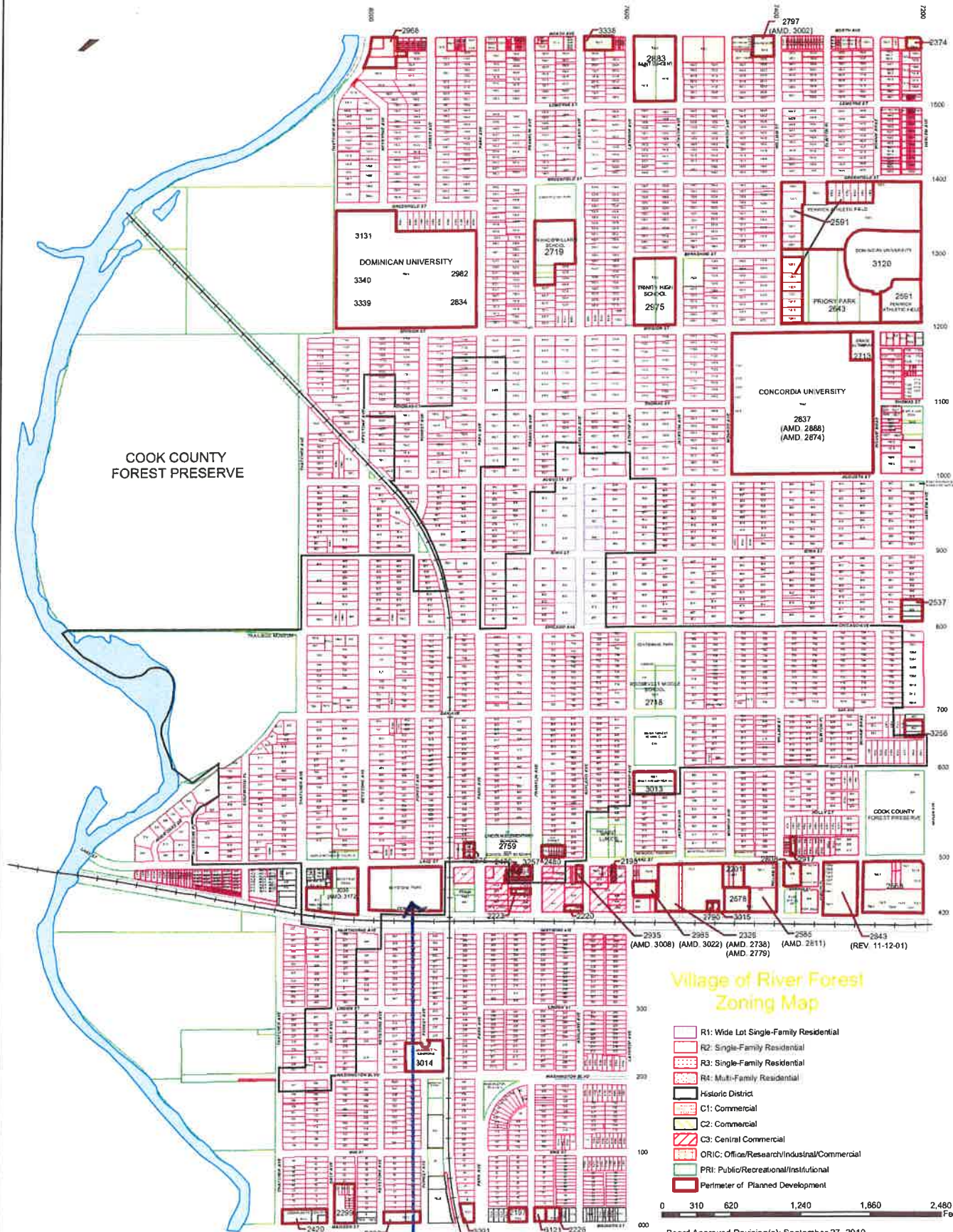

COOK COUNTY  
FOREST PRESERVE

3131  
DOMINICAN UNIVERSITY  
3340 2982  
3339 2834

CONCORDIA UNIVERSITY  
2837  
(AMD 2888)  
(AMD 2874)

3014

### Village of River Forest Zoning Map

- R1: Wide Lot Single-Family Residential
- R2: Single-Family Residential
- R3: Single-Family Residential
- R4: Multi-Family Residential
- Historic District
- C1: Commercial
- C2: Commercial
- C3: Central Commercial
- ORIC: Office/Research/Industrial/Commercial
- PRI: Public/Recreational/Institutional
- Perimeter of Planned Development



Board Approved Revision(s): September 27, 2010

**KEystone BATTINg CAve PROJECT**



NETS WITH PROTECTIVE NETS WOULD BE PLACED

ARCHITECTURAL & ENGINEERING CONSULTANTS, INC. 1111 11TH AVENUE, SUITE 1000, DENVER, CO 80202  
ARCHITECTURAL & ENGINEERING CONSULTANTS, INC. 1111 11TH AVENUE, SUITE 1000, DENVER, CO 80202  
ARCHITECTURAL & ENGINEERING CONSULTANTS, INC. 1111 11TH AVENUE, SUITE 1000, DENVER, CO 80202

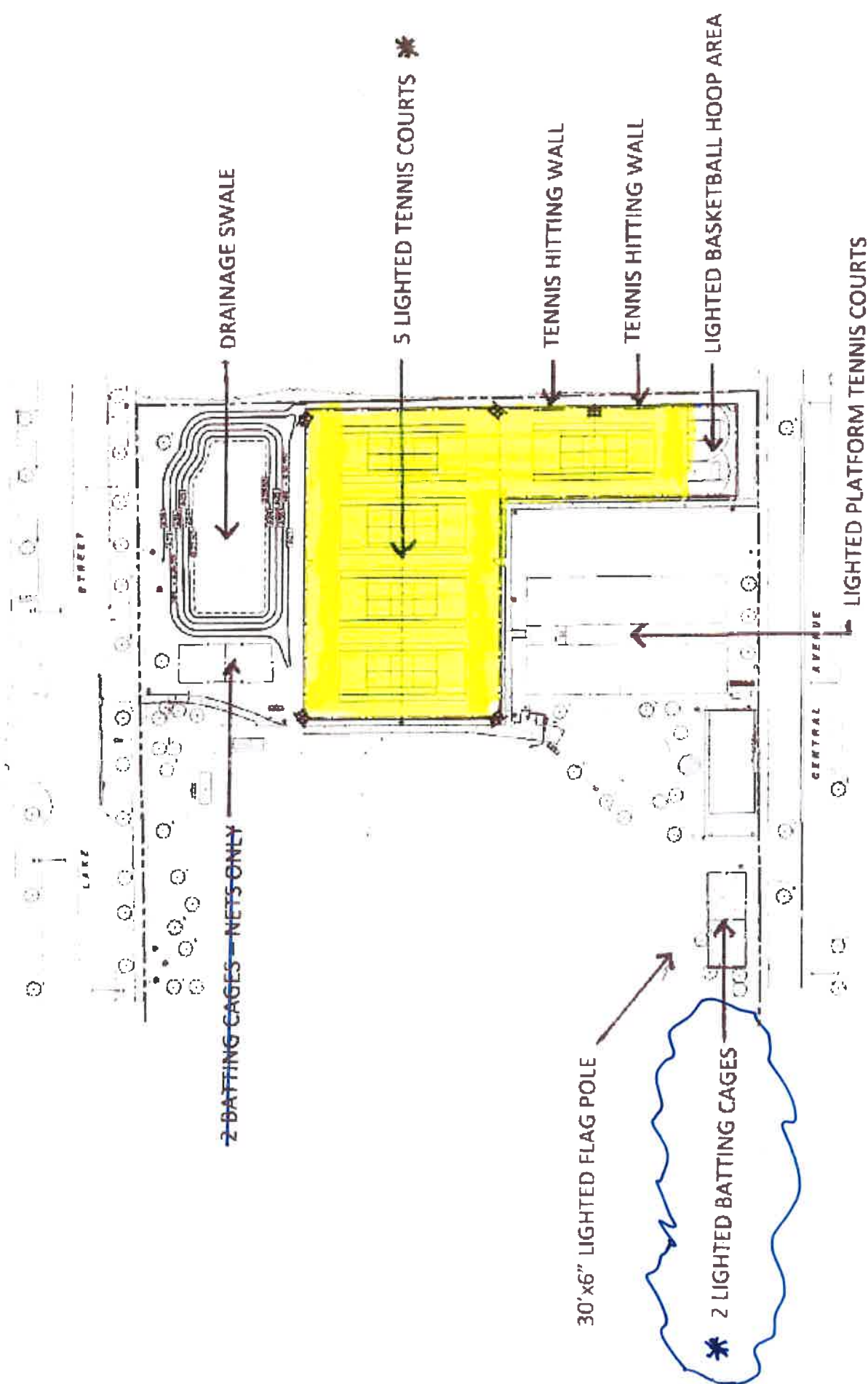

ACH TENNIS COURTS IS DUAL LINED FOR A PICKLE BALL COURT

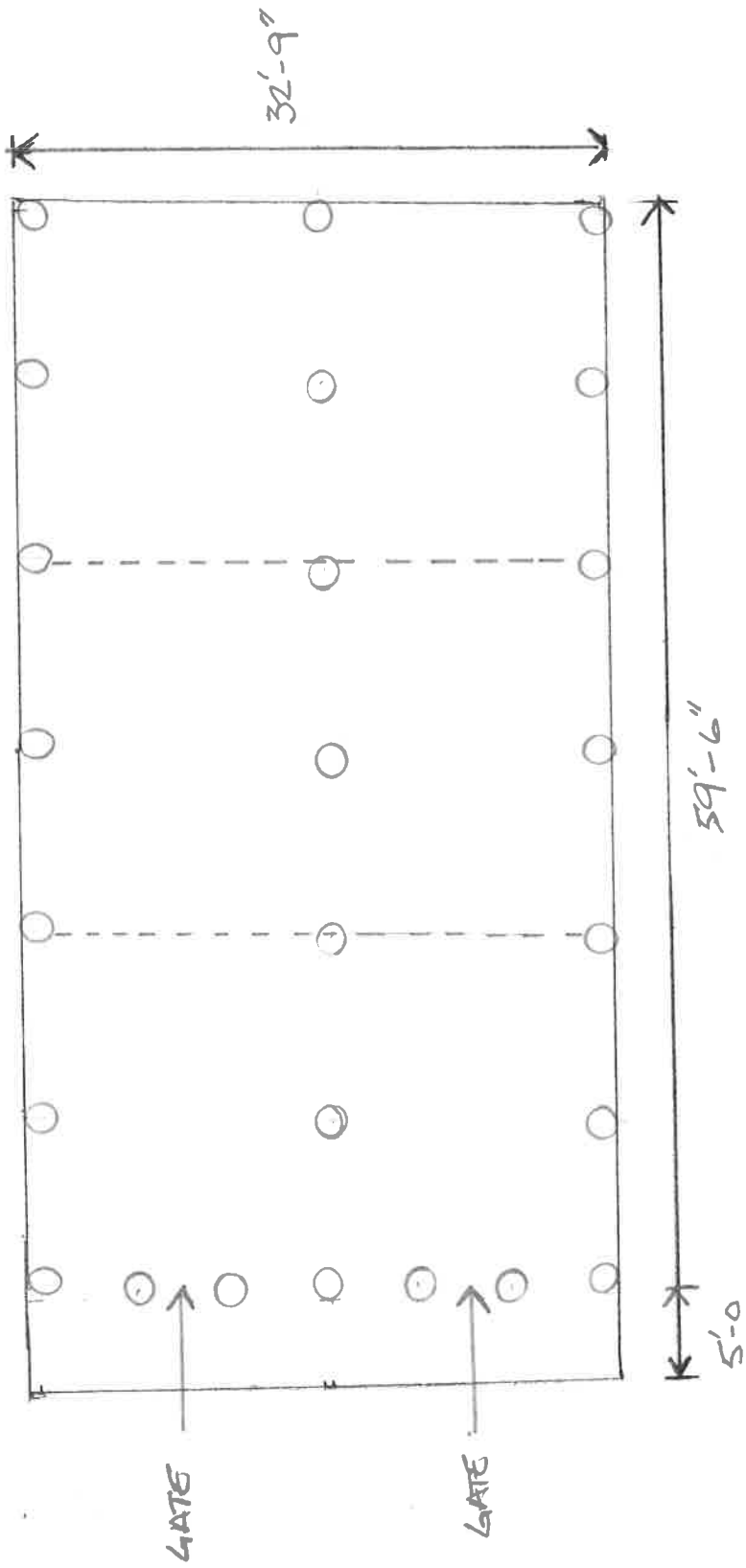

○ 3"Ø GALVANIZED POSTS

----- 3"Ø TOP RAIL SUPPORT

FENCE POST LAYOUT

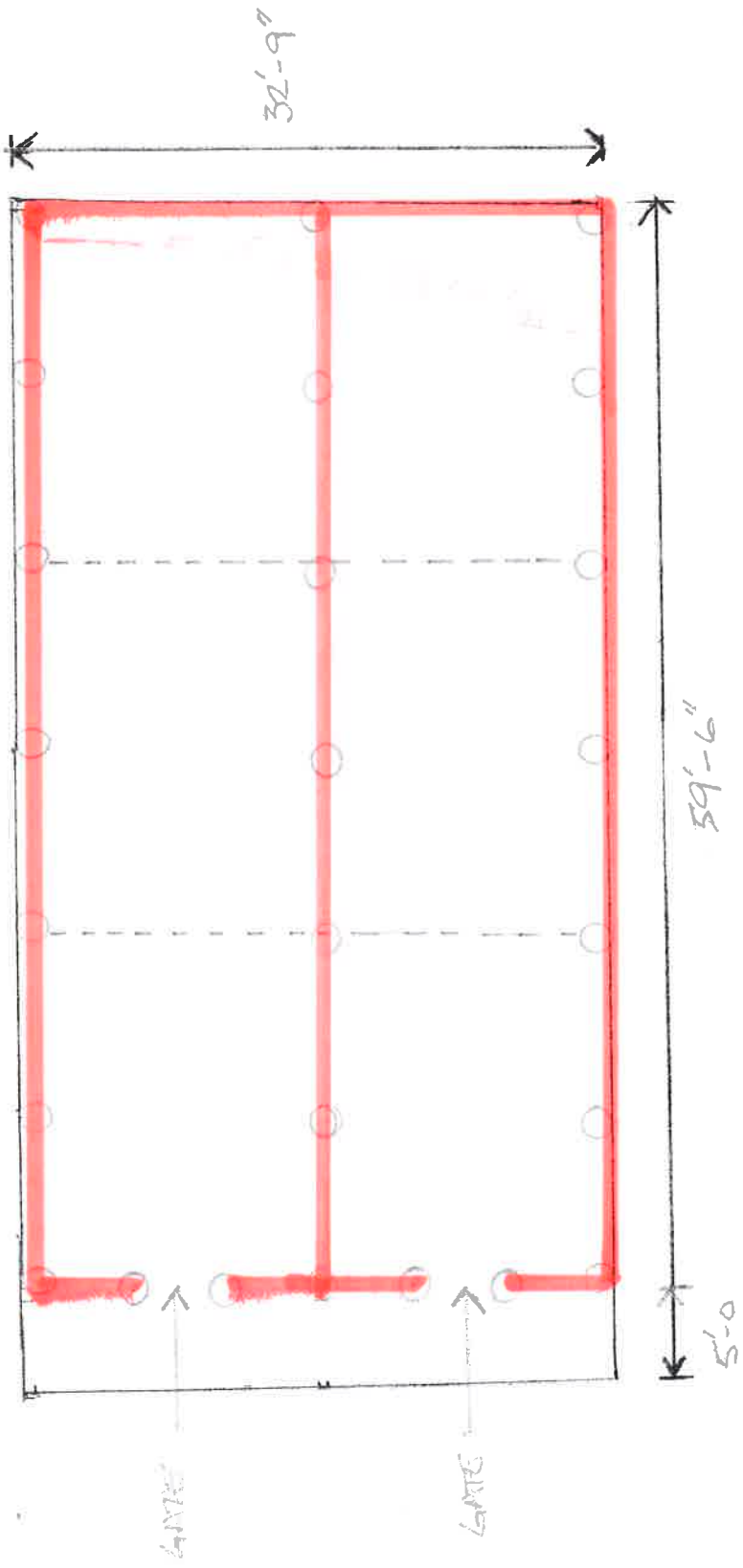

○ 3" OD GALVANIZED POSTS

----- 3" OD TOP RAIL SUPPORT

**1-5/8" RAIL & MESH**

FENCE RAIL & MESH LAYOUT